

- EMBED POLYESTER STITCH BOND FABRIC IN ANY AND ALL PLANE CHANGES
- APPLY POLYURETHANE CAULKING ON ALL FLASHING SEAMS AND OVERLAPS. STANDARD OVERLAP IS BOTTOM TO TOP WITH A 4" OVERLAP.
- $\frac{5}{8}$ " EXTERIOR GRADE MINIMUM FOR PLYWOOD OR OSB
- $\frac{1}{4}$ " MINIMUM SLOPE REQUIRED ON ALL DECKS
- REFER TO LOCAL BUILDING CODES & STANDARDS

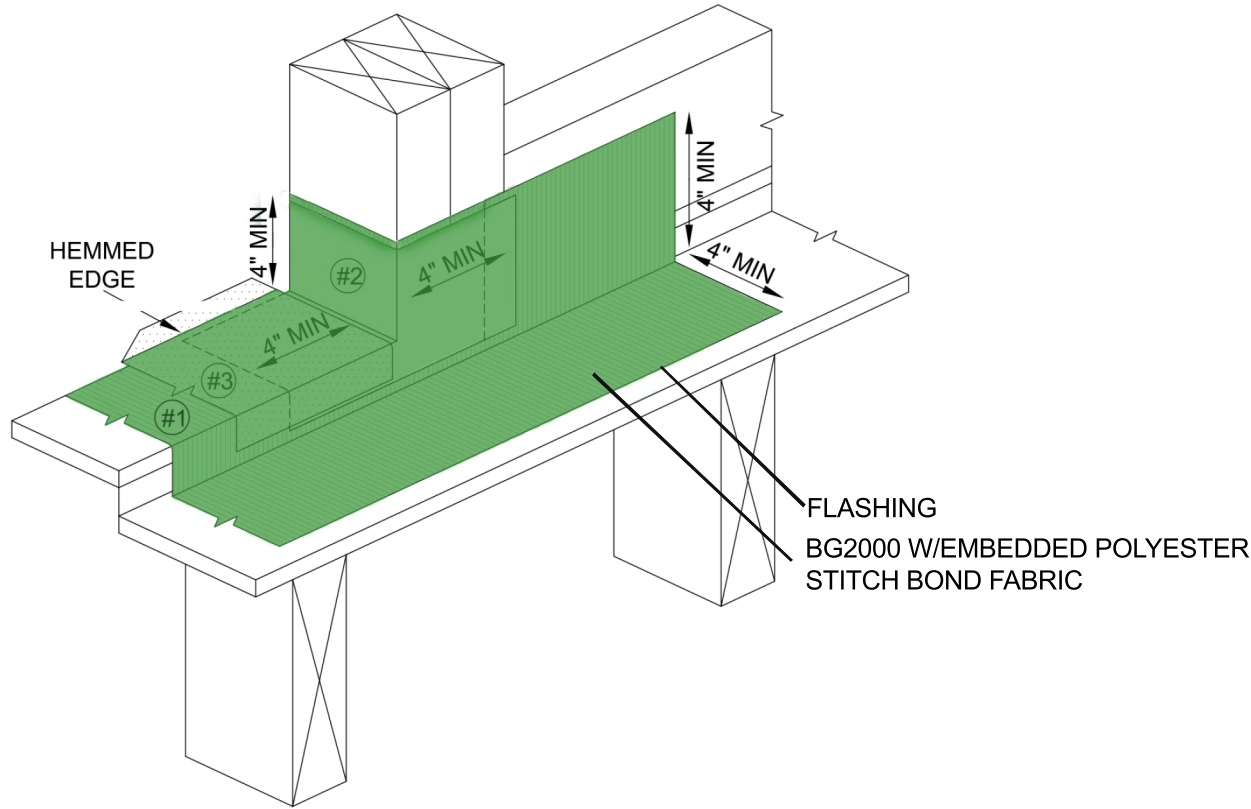

#### SITE BUILT PIECE

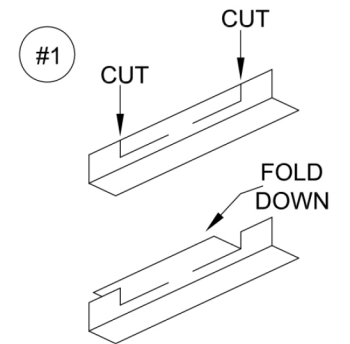

#### PREFAB. PIECES

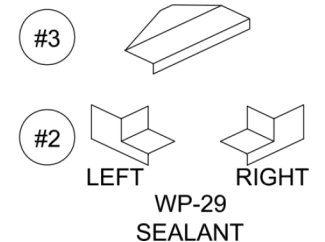

\* NOTE: For installation instructions please refer to the system specification sheets posted on our website. .

## TOPPING SLAB UNDERLAYMENT - THRESHOLD DETAILED DRAWING

2021

(949) 888-7100 | MULTICOAT CORPORATION 2021 | WWW.MULTICOAT.COM

